

## 絶縁丸サポーター(+)

INSULATED ROUND POSTS(+)



EOZ(+)



EOZ-1450

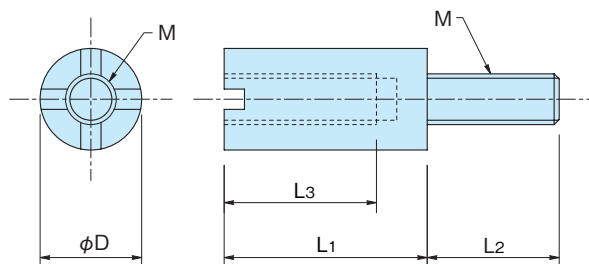

特 徴 Feature	<ul style="list-style-type: none"> <li>●先端が+字になっており、各種ドライバーで取り付け可能です。</li> <li>●It can be mounted in a variety of drivers because of plus-shaped tip.</li> </ul>
----------------	------------------------------------------------------------------------------------------------------------------------------------------------------------------

材 質	●鉄(SS)
表面処理	●絶縁チューブ/ポリオレフィン ●三価クロメートめっき・絶縁チューブ付

Material	●Rolled steel (SS)
Finish	●Insulating tube/Polyorefin ●Trivalent chromate With insulating tube

品 番 Product No.	M	L <sub>1</sub>	L <sub>2</sub>	L <sub>3</sub>	φD	自 重(g) Weight	入 数 Lot	単 価 Price
EOZ-1420	4	20	10	12	8	7.2	100	¥110
EOZ-1425	4	25	10	12	8	9.1	100	¥110
EOZ-1430	4	30	10	12	8	11.1	100	¥120
EOZ-1440	4	40	10	12	8	14.9	100	¥130
EOZ-1450	4	50	10	12	8	19.5	100	¥140
EOZ-1460	4	60	10	12	8	23.1	100	¥150
EOZ-1401	4	100	10	12	8	38.7	100	¥200
EOZ-1520	5	20	13	13	10	11	50	¥140
EOZ-1525	5	25	13	13	10	14	50	¥145
EOZ-1530	5	30	13	13	10	17	50	¥155
EOZ-1540	5	40	13	13	10	24	50	¥165
EOZ-1550	5	50	13	13	10	30	50	¥180
EOZ-1560	5	60	13	13	10	36	50	¥195
EOZ-1501	5	100	13	13	10	61	50	¥260

スペーサー  
支柱

## スペーサー(ガス管)

SPACER PIPES



EG(ss)



EG8-20

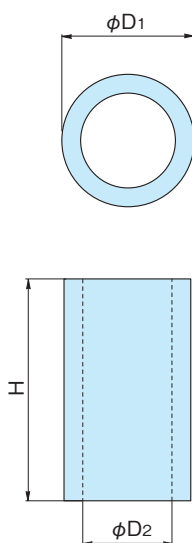

特 徴 Feature	<ul style="list-style-type: none"> <li>●機器取付時の空間の調整にご使用下さい。</li> <li>●Can be used in adjusting space when mounting the equipments.</li> </ul>
----------------	-----------------------------------------------------------------------------------------------------------------------------------------------

材 質	●鉄(SS)
表面処理	●三価クロメートめっき

Material	●Rolled steel (ss)
Finish	●Trivalent chromate plating

品 番 Product No.	φD <sub>1</sub>	φD <sub>2</sub>	H	自 重(g) Weight	単 価 Price
EG8-4.7	13.8	9.2	4.7	2.8	¥50
EG8-5.4	13.8	9.2	5.4	3.3	¥50
EG8-6.8	13.8	9.2	6.8	4.2	¥50
EG8-20	13.8	9.2	20	12.3	¥50
EG10-8.4	17.3	12.7	8.4	6.7	¥50
EG10-8.7	17.3	12.7	8.7	7	¥55
EG10-9.5	17.3	12.7	9.5	7.5	¥55
EG10-15	17.3	12.7	15	12	¥55
EG10-20	17.3	12.7	20	15.3	¥55
EG10-22	17.3	12.7	22	16.8	¥60
EG10-23	17.3	12.7	23	18.3	¥60
EG10-25	17.3	12.7	25	20.2	¥60
EG10-30	17.3	12.7	30	23.4	¥60
EG10-31	17.3	12.7	31	23.5	¥65
EG15-14	21.7	16.1	14	17.2	¥65
EG15-20	21.7	16.1	20	24.5	¥70
EG15-28	21.7	16.1	28	34	¥70
EG15-37	21.7	16.1	37	45.7	¥90
EG15-46	21.7	16.1	46	56.3	¥95
EG15-50	21.7	16.1	50	60.8	¥100